

DISPOSAL

HINT:

Dispose the RH side by the same procedures with the LH side.

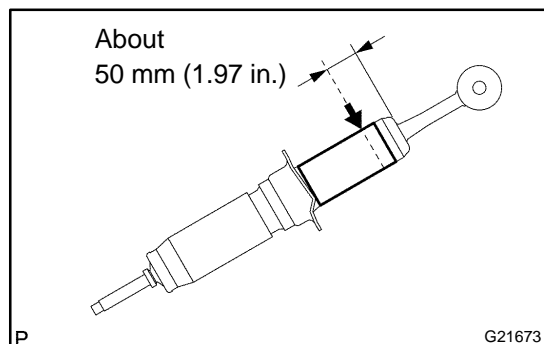

1. DISPOSE OF SHOCK ABSORBER ASSY FRONT LH (W/O REAS)

- (a) Fully extend the shock absorber piston rod, and fix it at a tilt in a vise or similar tool.
- (b) Using a drill or similar tool, slowly make a hole at approx. 5 cm from the top end of the shock absorber, and discharge the gas inside of it.

CAUTION:

- The gas is colorless, odorless and harmless.
- Since the discharged gas may cause chips to fly off, cover the drill with a shop rag when making a hole.

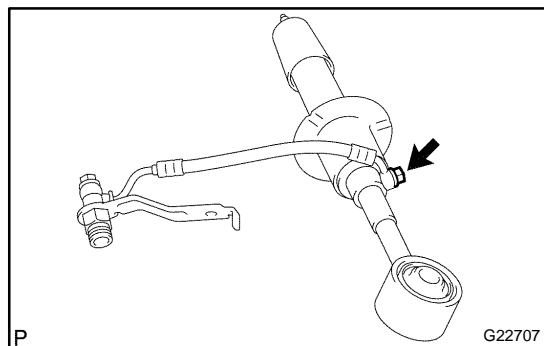

2. DISPOSE OF SHOCK ABSORBER ASSY FRONT LH (W/ REAS)

- (a) Before the disposal, loosen the nut slowly to bleed out the oil and to lower the pressure inside the absorber.

NOTICE:

Never loosen the nut of the eye union except the time of disposal.